

## Specification



**Pipeline Services  
International**

GmbH & Co. Kommanditgesellschaft

Thyssenstr. 2  
49744 Geeste - Dalum

Telefon 05937 980908-0  
Fax 05937 380908-190

[info@pressuretest.de](mailto:info@pressuretest.de)

# 48" **PSI** Multi-Channel Caliper-Tool

### General Information:

#### General Information:

Total Length:	approx. 2600 mm
Weight:	approx. 450 kg
No. of Modules:	1
No. of Sensor arms with Double Wheels:	40
Max survey lengths:	approx. 800 km
Battery life:	800 hrs
Recommended Tool Speed**:	0.1 – 3 m/s
Maximum Pressure:	100 bar
Temperature Range:	-20 to +80 °C
Minimum Bend Radius:	3D for 90° Bends (1.5D if requested)
Minimum ID in Straight Pipe:	914 mm / 75% of OD

### Following Features/ Installations can be detected

- Ovalities
- Dents
- Valves
- Bends
- Girth welds
- T-pieces
- Internal Diameter changes

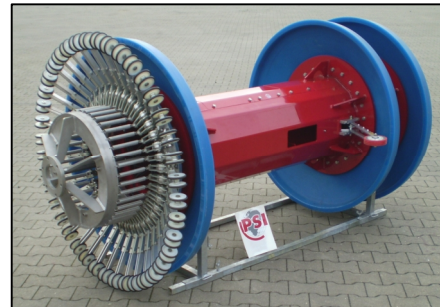

### Measurement Accuracy:

#### General Measurement:

Accuracy of distance information:	± 0.1m from reference girth weld
Accuracy of internal Diameter changes:	± 0.1 % / 1.22 mm
Dent:	± 0.1 % / 1.22 mm
Ovality:	± 0.1 % / 1.22 mm
Girth welds:	± 0.1 % / 1.22 mm
O'clock positioning:	± 4.5°

#### Sensitivity of the gauging System (threshold):

Dent & Ovality:	± 0.1 % / 1.22 mm
Girth welds:	± 0.1 % / 1.22 mm
Circumferential Location Accuracy:	± 5.0°

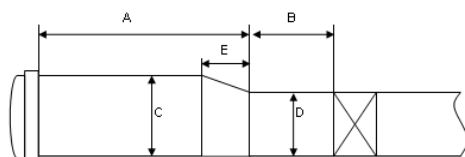

Note:  
All given values are related to the outer diameter.  
The above mentioned accuracies depend on acceptable run conditions:  
Constant speed during inspection, Clean pipe, Pipe book given to **PSI** department for evaluation.  
During the survey with compressed air, the pipeline must have a back pressure of 5 bars.  
\*\* At tool speeds above 3 m/s, the girth weld indications become inaccurate due to dynamic overreaction  
of the sensing fingers. For best results we recommend tool speeds between 0.1 and 1.5 m/s.  
**PSI** reserves the right to introduce technical changes and modifications without prior notice.

### Recommended Dimensions for Launcher and Receiver

Dimension	Launcher	Receiver
A	> 2800 mm	> 2800 mm
B	> 500 mm	> 500 mm
C	> 1.1 D	> 1.1 D
D	48"	48"
E	610 mm	610 mm